

PRESENTED:
CAVITIES OPEN
Darstellung:
Kammern offen

BETWEEN THE CAVITIES MATERIAL RECESSES PERMITTED
Materialausparungen zwischen den Kammern zulässig

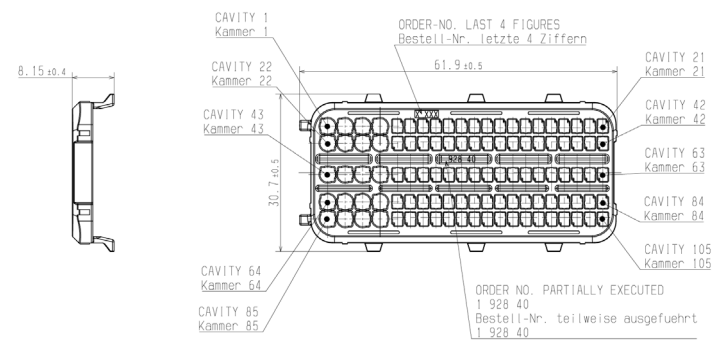
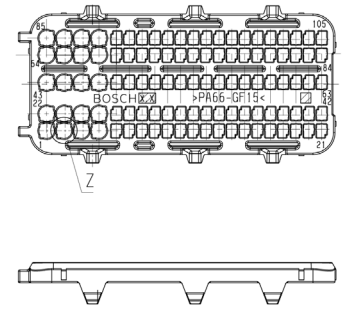
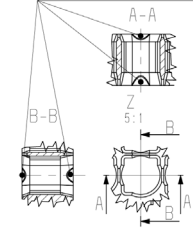

ORDER-NO. LAST 4 FIGURES
Bestell-Nr. letzte 4 Ziffern

ORDER NO. PARTIALLY EXECUTED
1 928 40
Bestell-Nr. teilweise ausgeführt
1 928 40

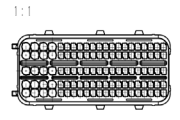

PRESENTED (EXAMPLE):
MINOR VARIANTS OF ASSEMBLING
Darstellung (Beispiel):
Variante fuer Minderbestueckung

VERSION 1
FOR WIRE SIZE RANGE
1.0-1.5mm² FLR-WIRE (MAX.20x)
Ausfuehrung 1
f. Leitungsquerschnitt
1.0-1.5mm² FLR-Leitung (max.20x)

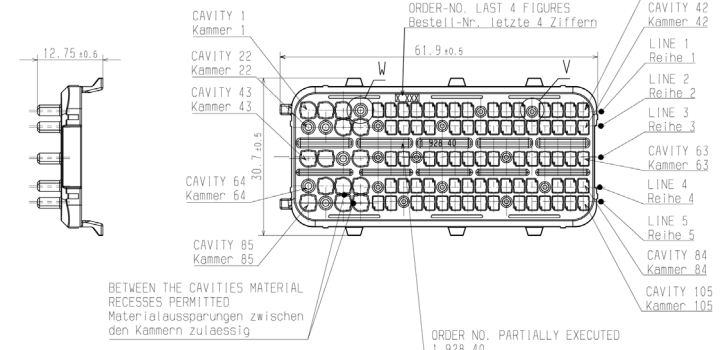
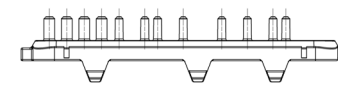
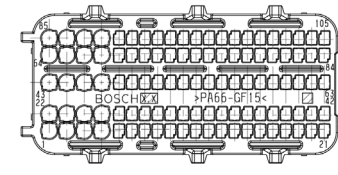

ORDER NO. PARTIALLY EXECUTED
1 928 40
Bestell-Nr. teilweise ausgeführt
1 928 40

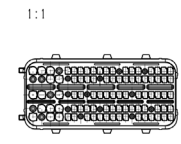

VERSION 2
FOR WIRE SIZE RANGE
0.35-0.75mm² FLR-WIRE (MAX.85x)
Ausfuehrung 2
f. Leitungsquerschnitt
0.35-0.75mm² FLR-Leitung (max.85x)

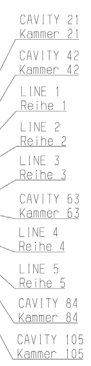

MINIMUM ORDER QUANTITY: 1 PACKAGE
Mindestbestellmenge: 1 Packeinheit

FOR REDUCTION OF THE NUMBER OF VARIANTS ADDITIONAL
UP TO 6 BLIND TERMINALS HAVE TO BE USED
(IN CASE OF EXCEEDING, NEW VERSION OF HOLDING PLATE)
Zur Verringerung der Variantenzahl sind zusätzlich
bis zu 6 Dichtstifte einzusetzen
(bei Überschreitung: neue Halteplattenversion)

ITEM Pos.	DESIGNATION Benennung	SEE TAB./s. Tab. ORDER No. Bestell-Nr.	PA 66 - GF 15 MATERIAL COLOUR Stoff Farbe	REMARKS Bemerkungen
1	HOLDING PLATE Halteplatte	SEE TAB./s. Tab.	PA 66 - GF 15	BLACK schwarz

General tolerances for all geometric features (see also ISO 1101)	mm
±0.5mm	±0.5mm
±0.1mm	±0.1mm
±0.05mm	±0.05mm
±0.02mm	±0.02mm

Change/Mod.	YYYYMMDD	Drawn/Gez.	Checked/Gepr.	Released/ Freig.	Drawn/Gez.	Checked/Gepr.	Released/ Freig.	Drawn/Gez.	Checked/Gepr.	Released/ Freig.
22	MODIFIED	20140519	vbo/klar	ri/klar	-	213005	AM/ENC	-	-	-
21	MODIFIED	20140428	vbo/klar	ri/klar	-	213005	AM/ENC	-	-	-
20	MODIFIED	20140321	ri/klar	si/klar	-	213005	AM/ENC	-	-	-
01	NEW EDITION	20070314	Co	Hk	Lx	213005	AM/ENC	-	-	-

PARTS MAY BE DIFFER IN NON-FUNCTIONAL DETAILS FROM THE REPRESENTATION IN THIS DRAWING
Teile koennen in nicht funktionsrelevanten Details von der Darstellung in dieser Zeichnung abweichen

BOSCH HOLDING PLATE HALTEPLATTE
AGZ 1 928 A00 479
OFFER DRAWING ANGEBOTSZEICHNUNG

PART- / ORDER-NO. Sach- / Bestell-Nr.	NUMBER OF OPEN CAVITIES (...) Anzahl offene Kammern (...)	POSITION OF CAVITY/NUMBER OF CAVITY / Kammerposition/Kammernummer																																																														
		0... CAVITY CLOSED SEE VERSION 1 / Kammer geschlossen n. Ausfuehrung 1																															/ X... CAVITY CLOSED SEE VERSION 2 / Kammer geschlossen n. Ausfuehrung 2																															
		LINE 1 / Reihe 1															LINE 2 / Reihe 2																LINE 3 / Reihe 3																															
		1	2	3	4	5	6	7	8	9	10	11	12	13	14	15	16	17	18	19	20	21	22	23	24	25	26	27	28	29	30	31	32	33	34	35	36	37	38	39	40	41	42	43	44	45	46	47	48	49	50	51	52	53	54	55	56	57	58	59	60	61	62	63
② 1 928 405 933	(68)			X	X	X			X		X							X						0		X	X		X				X					X	X						X	X	X	X		X					X	X	X							
② 1 928 405 934	(66)			X	X	X		X	X		X												0		X	X				X					X									X	X	X	X					X				X	X	X						
② 1 928 405 935	(71)	0	0	0			X			X	X					X	X	X					0															X				0		X			X			X	X	X		X	X	X								
② 1 928 405 936	(65)	0	0	0			X	X		X	X					X	X	X					0					X		X												0		X			X	X		X	X	X		X	X	X								
② 1 928 405 937	(75)	0	0	0			X			X	X					X	X	X					0																			0					X			X	X	X		X			X							
		LINE 4 / Reihe 4															LINE 5 / Reihe 5																																															
		64	65	66	67	68	69	70	71	72	73	74	75	76	77	78	79	80	81	82	83	84	85	86	87	88	89	90	91	92	93	94	95	96	97	98	99	100	101	102	103	104	105																					
② 1 928 405 933	(68)					X			X	X		X	X		X		X			X	0	0				X	X		X	X													X			X																		
② 1 928 405 934	(66)				X	X	X		X	X		X	X		X		X	X	0	0					X	X	X		X	X														X			X																	
② 1 928 405 935	(71)		0	X		X			X	X		X	X	X	X	X	X	X	X	X	X			0					X		X	X	X																															
② 1 928 405 936	(65)		0	X		X	X		X	X	X		X	X	X	X	X	X	X	X	X	X			0				X		X	X	X																															
② 1 928 405 937	(75)		0			X			X	X	X		X	X	X		X	X	X	X	X	X			0				X		X		X	X																														

* VIEW FOR EXAMPLE (SEE SHEET 1)
* Beispieldarstellung (siehe Blatt 1)

general tolerances for all geometrical features (see also...)																																																													
±0,5mm			±0,5mm			±5°																																																							
all linear dimensions in mm																																																													
drawing standard: ISO Standard																																																													
<table border="1"> <tr> <th>QTY</th><th>MODIFIED</th><th>DATE</th><th>BY</th><th>REASON</th><th>QTY</th><th>MODIFIED</th><th>DATE</th><th>BY</th><th>REASON</th> </tr> <tr> <td>22</td><td>MODIFIED</td><td>20140219</td><td>vbf/akar</td><td>riol/akar</td><td>-</td><td>21</td><td>30105-AM/ENC</td><td>-</td><td>-</td> </tr> <tr> <td>21</td><td>MODIFIED</td><td>20140428</td><td>vbf/akar</td><td>riol/akar</td><td>-</td><td>21</td><td>30105-AM/ENC</td><td>-</td><td>-</td> </tr> <tr> <td>20</td><td>MODIFIED</td><td>20140321</td><td>riol/akar</td><td>s14/akar</td><td>-</td><td>21</td><td>30105-AM/ENC</td><td>-</td><td>-</td> </tr> <tr> <td>01</td><td>NEW EDITION</td><td>20070314</td><td>Co</td><td>Mh</td><td>Lx</td><td>21</td><td>30105-AM/ENC</td><td>-</td><td>-</td> </tr> </table>												QTY	MODIFIED	DATE	BY	REASON	QTY	MODIFIED	DATE	BY	REASON	22	MODIFIED	20140219	vbf/akar	riol/akar	-	21	30105-AM/ENC	-	-	21	MODIFIED	20140428	vbf/akar	riol/akar	-	21	30105-AM/ENC	-	-	20	MODIFIED	20140321	riol/akar	s14/akar	-	21	30105-AM/ENC	-	-	01	NEW EDITION	20070314	Co	Mh	Lx	21	30105-AM/ENC	-	-
QTY	MODIFIED	DATE	BY	REASON	QTY	MODIFIED	DATE	BY	REASON																																																				
22	MODIFIED	20140219	vbf/akar	riol/akar	-	21	30105-AM/ENC	-	-																																																				
21	MODIFIED	20140428	vbf/akar	riol/akar	-	21	30105-AM/ENC	-	-																																																				
20	MODIFIED	20140321	riol/akar	s14/akar	-	21	30105-AM/ENC	-	-																																																				
01	NEW EDITION	20070314	Co	Mh	Lx	21	30105-AM/ENC	-	-																																																				
<table border="1"> <tr> <th>Lang./Spr.</th><th>Spst.</th><th>Richt./Gen.</th><th>Spst./Gen.</th><th>Spst./Gen.</th><th>Spst./Gen.</th><th>Spst./Gen.</th><th>Spst./Gen.</th><th>Spst./Gen.</th><th>Spst./Gen.</th><th>Spst./Gen.</th><th>Spst./Gen.</th> </tr> <tr> <td>en/</td><td></td><td>YYYMMDD</td><td>Spst./Gen.</td><td>Checked/Spst.</td><td>Checked/Spst.</td><td>Checked/Spst.</td><td>Checked/Spst.</td><td>Checked/Spst.</td><td>Checked/Spst.</td><td>Checked/Spst.</td><td>Checked/Spst.</td> </tr> </table>												Lang./Spr.	Spst.	Richt./Gen.	Spst./Gen.	Spst./Gen.	Spst./Gen.	Spst./Gen.	Spst./Gen.	Spst./Gen.	Spst./Gen.	Spst./Gen.	Spst./Gen.	en/		YYYMMDD	Spst./Gen.	Checked/Spst.	Checked/Spst.	Checked/Spst.	Checked/Spst.	Checked/Spst.	Checked/Spst.	Checked/Spst.	Checked/Spst.																										
Lang./Spr.	Spst.	Richt./Gen.	Spst./Gen.	Spst./Gen.	Spst./Gen.	Spst./Gen.	Spst./Gen.	Spst./Gen.	Spst./Gen.	Spst./Gen.	Spst./Gen.																																																		
en/		YYYMMDD	Spst./Gen.	Checked/Spst.	Checked/Spst.	Checked/Spst.	Checked/Spst.	Checked/Spst.	Checked/Spst.	Checked/Spst.	Checked/Spst.																																																		
<table border="1"> <tr> <th>Lang./Spr.</th><th>Spst.</th><th>Richt./Gen.</th><th>Spst./Gen.</th><th>Spst./Gen.</th><th>Spst./Gen.</th><th>Spst./Gen.</th><th>Spst./Gen.</th><th>Spst./Gen.</th><th>Spst./Gen.</th><th>Spst./Gen.</th><th>Spst./Gen.</th> </tr> <tr> <td>en/</td><td></td><td>2:1</td><td>Spst./Gen.</td><td>Spst./Gen.</td><td>Spst./Gen.</td><td>Spst./Gen.</td><td>Spst./Gen.</td><td>Spst./Gen.</td><td>Spst./Gen.</td><td>Spst./Gen.</td><td>Spst./Gen.</td> </tr> </table>												Lang./Spr.	Spst.	Richt./Gen.	Spst./Gen.	Spst./Gen.	Spst./Gen.	Spst./Gen.	Spst./Gen.	Spst./Gen.	Spst./Gen.	Spst./Gen.	Spst./Gen.	en/		2:1	Spst./Gen.	Spst./Gen.	Spst./Gen.	Spst./Gen.	Spst./Gen.	Spst./Gen.	Spst./Gen.	Spst./Gen.	Spst./Gen.																										
Lang./Spr.	Spst.	Richt./Gen.	Spst./Gen.	Spst./Gen.	Spst./Gen.	Spst./Gen.	Spst./Gen.	Spst./Gen.	Spst./Gen.	Spst./Gen.	Spst./Gen.																																																		
en/		2:1	Spst./Gen.	Spst./Gen.	Spst./Gen.	Spst./Gen.	Spst./Gen.	Spst./Gen.	Spst./Gen.	Spst./Gen.	Spst./Gen.																																																		
<table border="1"> <tr> <th>Lang./Spr.</th><th>Spst.</th><th>Richt./Gen.</th><th>Spst./Gen.</th><th>Spst./Gen.</th><th>Spst./Gen.</th><th>Spst./Gen.</th><th>Spst./Gen.</th><th>Spst./Gen.</th><th>Spst./Gen.</th><th>Spst./Gen.</th><th>Spst./Gen.</th> </tr> <tr> <td>en/</td><td></td><td>AGZ</td><td>1</td><td>928</td><td>A00</td><td>479</td><td>001</td><td>22</td><td>AI</td><td></td><td></td> </tr> </table>												Lang./Spr.	Spst.	Richt./Gen.	Spst./Gen.	Spst./Gen.	Spst./Gen.	Spst./Gen.	Spst./Gen.	Spst./Gen.	Spst./Gen.	Spst./Gen.	Spst./Gen.	en/		AGZ	1	928	A00	479	001	22	AI																												
Lang./Spr.	Spst.	Richt./Gen.	Spst./Gen.	Spst./Gen.	Spst./Gen.	Spst./Gen.	Spst./Gen.	Spst./Gen.	Spst./Gen.	Spst./Gen.	Spst./Gen.																																																		
en/		AGZ	1	928	A00	479	001	22	AI																																																				