

3.2 Pressure sensors

Absolute pressure sensor



Product type

DS-S3-TF

Part number

0 261 230 310

Picture



Dimensional drawings

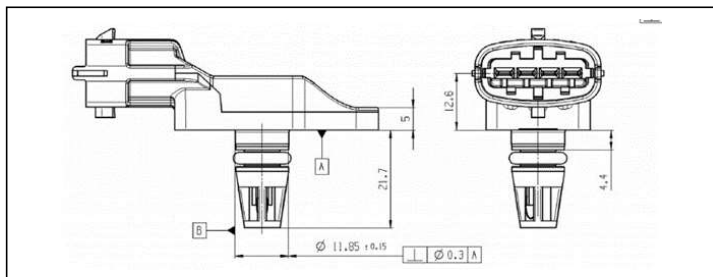

Characteristic curve

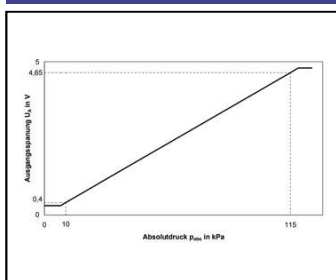

Technical data

Parameter	min.	type	Max.
Features	Integrated temperature sensor		
Pressure range ($p_1...p_2$)	kPa	10	115
Supply voltage U_V	V	4,75	5,25
Response time $\tau_{10/90}$	ms	1	
Operating temperature	°C	-40	+130
Load current I_L at output	mA	-1	0,5
Operating temperature	°C	-40	+130
Lower limit at $U_S = 5$ V	V	0,25	0,3
Upper limit at $U_S = 5$ V	V	4,65	4,7

Accessories

Connector housing	4-pin	1 928 404 745
Contact pins (gold-plated)	For \varnothing 0.5...1.0 mm ²	1 928 498 054
Contact pins (gold-plated)	For \varnothing 1.5...2.5 mm ²	1 928 498 055
Single-wire seal	For \varnothing 0.35...1.0 mm ²	1 928 300 599
Single-wire seal	For \varnothing 1.5...2.5 mm ²	1 928 300 600
Dummy plug		1 928 300 601

Accessories are not included in the scope of delivery of the sensor and therefore to be ordered separately as required.

[▶ Product groups](#)