

Diese Zeichnung ist unser geistiges Eigentum und darf ohne unsere Einwilligung weder kopiert, vervielfältigt noch Dritten oder Konkurrenzfirmen zugänglich gemacht werden. (Art. 12 B.G.)  
 This drawing is copyright. Information contained thereon is supplied in confidence and must not be used for any other purpose than which it was supplied, or be reproduced without written permission of the owners.

32\_MMBX-50-0-3

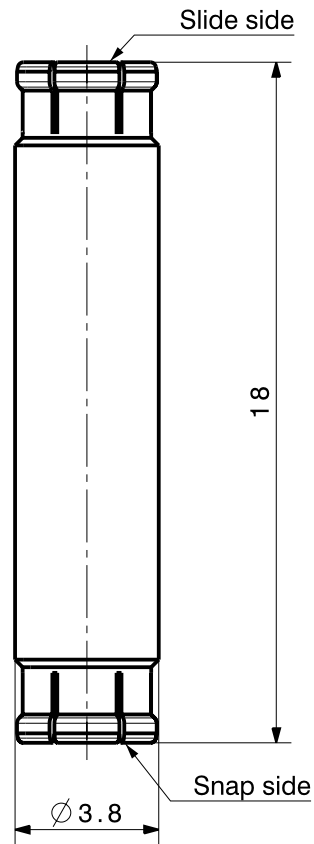

A "blind" assembly of the two PCB's is not possible. We recommend a manual lead-in or an additional mechanical guidance.

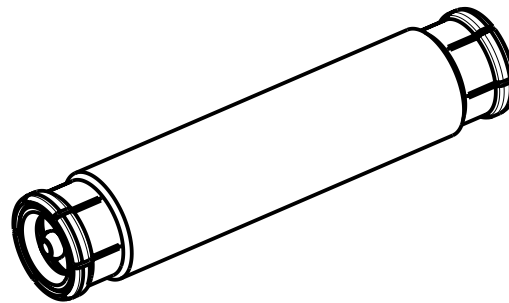

MMBX application instructions are available at [www.hubersuhner.com](http://www.hubersuhner.com) or from your local HUBER+SUHNER sales representative

### Radial and axial working range

The radial and axial working range is the maximum misalignment that allows a sufficient electrical and mechanical connection.

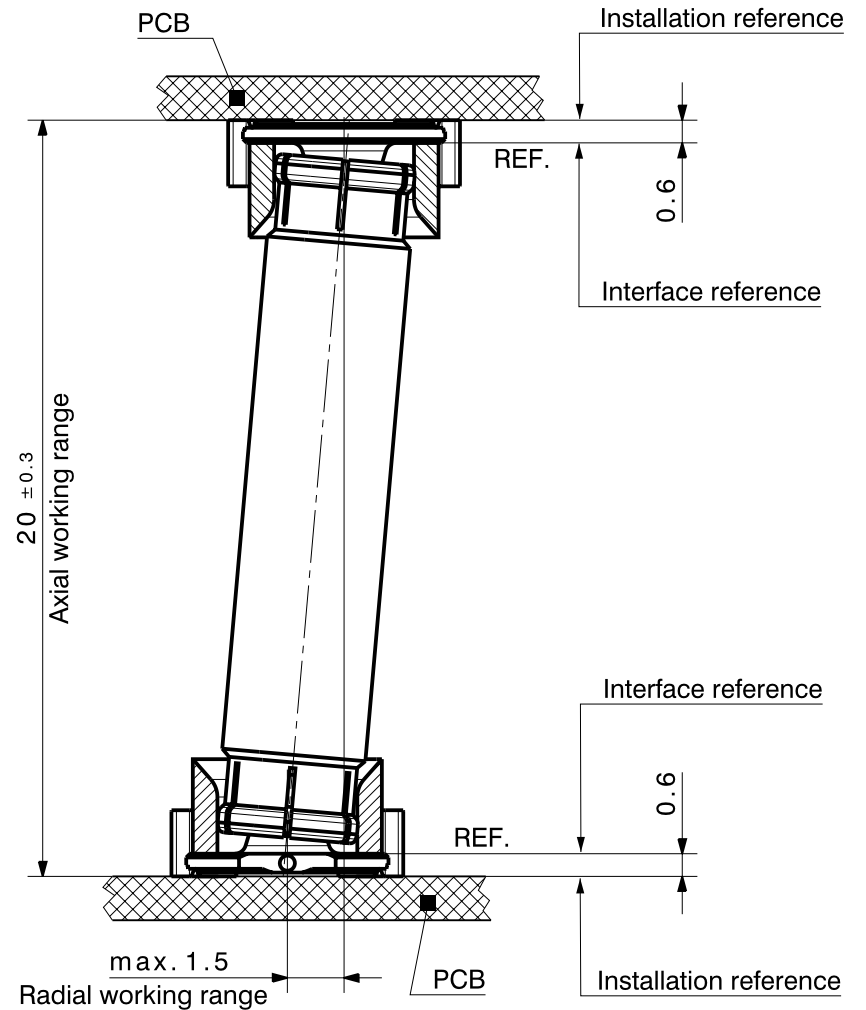

type / Typ: 32\_MMBX-50-0-3

⊕ dimensions in millimeter [mm]

part no. / Teile Nr.: PRO-00013787 B sheet/Blatt XX / XX

description / Beschreibung

drawing-no. / Zeichnungsnr.

Release

Adaptor

DOU-00013787

D

alternative ID: 4.13.34251