

Diese Zeichnung ist unser geistiges Eigentum und darf ohne unsere Ermächtigung weder kopiert, vervielfältigt noch Dritten oder Konkurrenzfirmen zugänglich gemacht werden. (Art. 12 B.G.)
 This drawing is copyright. Information contained thereon is supplied in confidence and must not be used for any other purpose than which it was supplied, or be reproduced without written permission of the owners.

32_MMBX-50-0-6

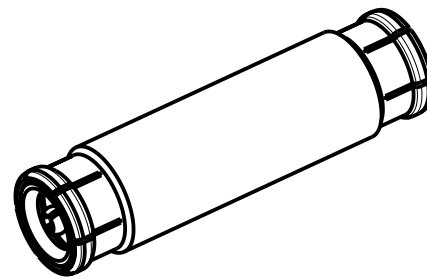
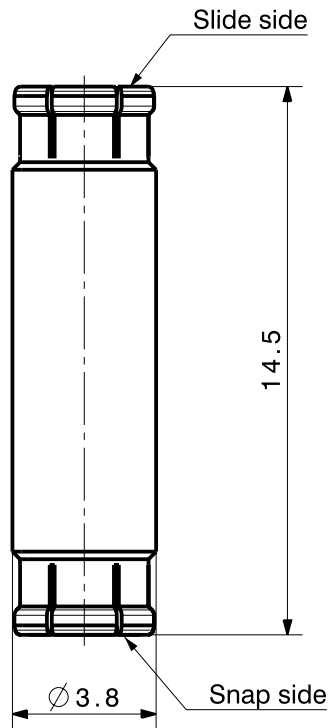

A "blind" assembly of the two PCB's is not possible. We recommend a manual lead-in or an additional mechanical guidance.

Radial and axial working range

The radial and axial working range is the maximum misalignment that allows a sufficient electrical and mechanical connection.

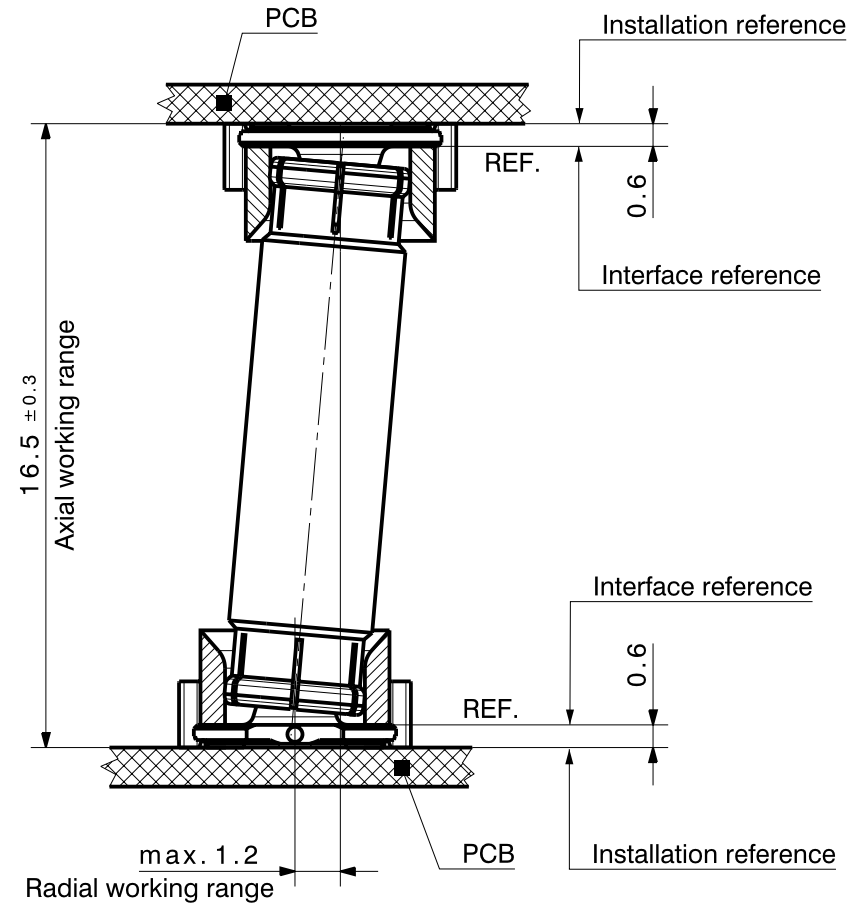

MMBX application instructions are available at www.hubersuhner.com or from your local HUBER+SUHNER sales representative



type / Typ: 32_MMBX-50-0-6			
⊕ dimensions in millimeter [mm]	part no. / Teile Nr.: PRO-00013789	B sheet/Blatt XX / XX	
description / Beschreibung	drawing-no. / Zeichnungsnr.	Release	
Adaptor	DOU-00013789	C	
alternative ID: 4.13.33810			