

AHC1



Family features:

- ▶ With and without hall sensor
- ▶ Degree of protection: IP 50
- ▶ Operation mode: S2
- ▶ Hollow shaft
- ▶ Direction of rotation: CCW/CW

Voltage	Part number	P _n (Nominal power)	I _n (Nominal current)	n _n (Nominal speed)	M _n (Nominal torque)	M _a (Stall torque)	Gear ratio	Signal	Side**	Dimensional drawing (D)	Wiring diagram (W)	Drive end (S)	Connector (C)	Performance curve (P)
		W	A	rpm	Nm	Nm								
12 V	0 390 201 900	8.8	5	845	0.1	1.05	27:4	No	R	D1	W1	S1	C1	P1
	0 390 201 912	8.8	5	845	0.1	1.05	27:4	No	L	D1	W1	S1	C1	P1
	0 390 201 914	8.8	5	845	0.1	1.05	27:4	Yes	L	D1	W2	S1	C2	P1
	0 390 203 371	12.9	4	411	0.3	1.5	27:4	Yes	L	D1	W2	S2	C2	P6
	0 390 201 901	8.6	5	820	0.1	1.5	27:4	No	R	D1	W1	S1	C1	P2
	0 390 201 903	8.6	5	820	0.1	1.5	27:4	Yes	R	D1	W2	S1	C2	P2
	0 390 201 915	8.6	5	820	0.1	1.5	27:4	Yes	L	D1	W2	S1	C2	P2
	0 390 203 370	6.6	3.8	210	0.3	2.8	28:2	Yes	L	D1	W4	S2	C2	P7
	0 390 203 431	13.2	7	63	2	5.8	50:1	Yes	L	D3	W3	S3	C2	P3
	0 390 203 389	2.4	2	75	0.3	1.8	29:1	Yes	L	D1	W6	S2	C2	P8
	0 390 203 045	1.3	4.2	6.4	2	27.5	506:1	Yes	L	D2	W6	S4	C2	P9
0 390 203 046	1.3	4.2	6.4	2	27.5	506:1	Yes	R	D2	W6	S4	C2	P9	
24 V	0 390 203 316	8.8	3.2	841	0.1	1.85	27:4	Yes	R	D1	W3	S2	C2	P4
	0 390 203 317	8.8	3.2	841	0.1	1.85	27:4	Yes	L	D1	W3	S2	C2	P4
	0 390 203 386	15.6	4.8	99.5	1.5	11	50:1	2x Hall*	L	D4	W5	S3	C1	P5

* Optional (0 986 196 002) / **gear housing left: L, gear housing right: R

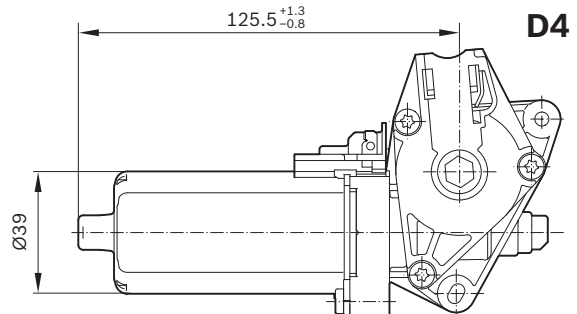
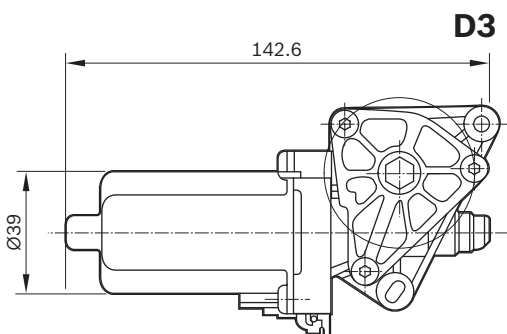
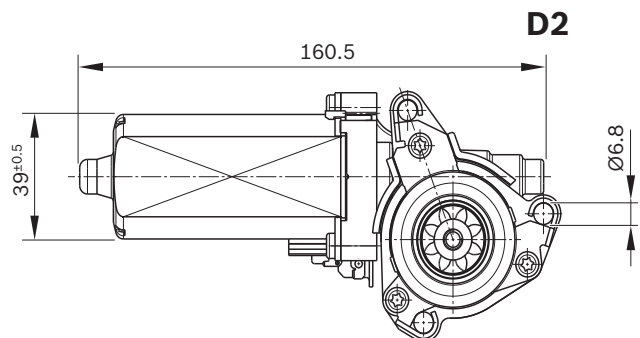
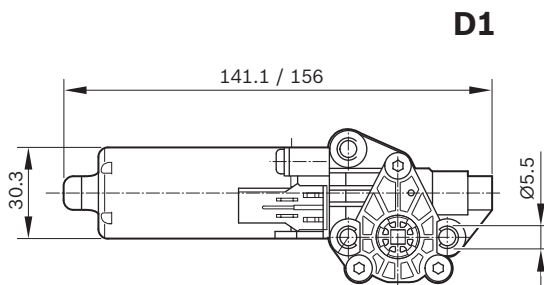

AHC1

Wiring diagram (W)

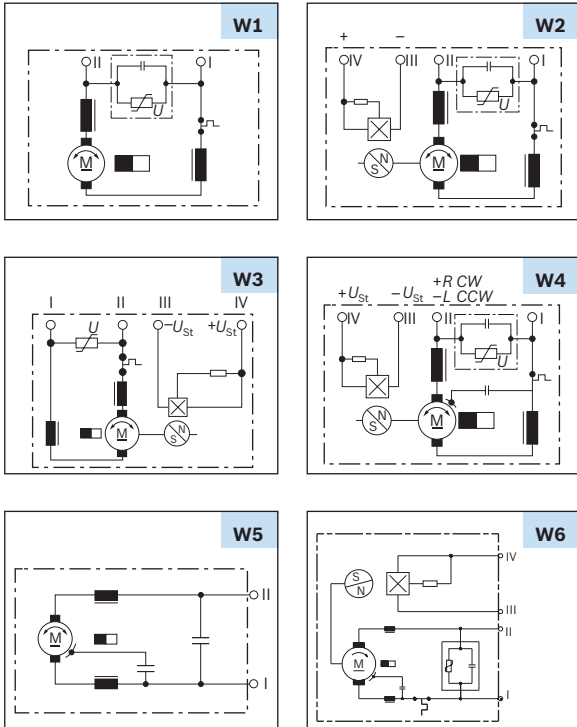

Performance curve (P)

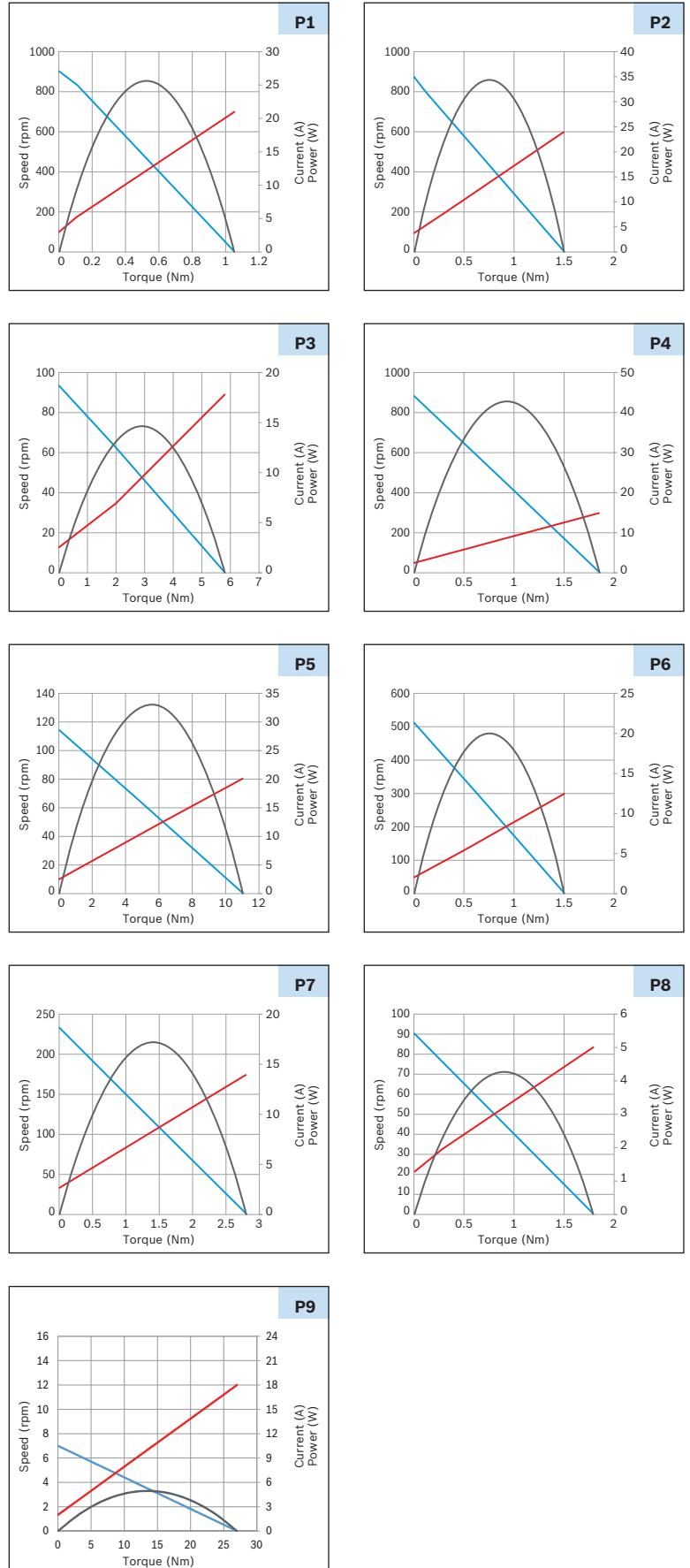

Drive end (S)

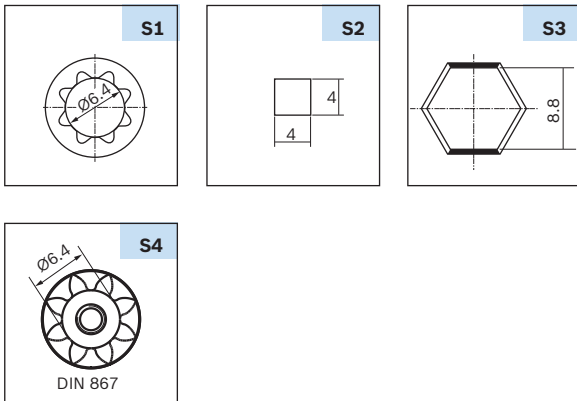

Mating connector (C)

